

MULTI-USE TRAIL SYSTEM



Trail System and Amenities

- The lit, paved, 4 metre wide **Primary Multi-use Pathway** runs from Malden Road to the Howard Avenue Diversion and allows pedestrians and cyclists to travel end-to-end the length of the Parkway, without encountering vehicles, using trail bridges and tunnels.
- A **Secondary Trail System** provides community connections and access for emergency and maintenance vehicles. The secondary trails use at-grade crossings at signalized intersections and connect to the primary multi-use pathway.
- **Trailheads** are located at Malden Road, Howard Avenue, and Howard Avenue Diversion and include a bench, waste and recycling receptacle, and wayfinding signage.
- **Rest Areas** are provided throughout the trail system, furnished with decorative paving, bench, recycling/waste receptacle, trail map signboard and an emergency call station. Some have shade structures and interpretive signs.
- **Urban rest areas** are located on the tunnel tops along the primary multi-use pathway and are finished with decorative pavers.
- **Lay-bys**, areas for rest, are located along the trail system and have granular surfacing, limestone blocks for seating, and interpretive signs (where applicable). They are meant to be less formal, rustic and in keeping with the natural surroundings.
- **Emergency call stations** are located at trailheads, urban rest areas, key lay-bys, trail intersections and isolated sections of the trail system.
- **Informational** (including regulatory and warning signs), **wayfinding** and **interpretive signs** are located throughout the trail system.

The Parkway is set within **120 hectares (300 acres)** of green space, comprised of an interconnected system of environmental and landscaped areas, and accessed by a Multi-use Trail System.

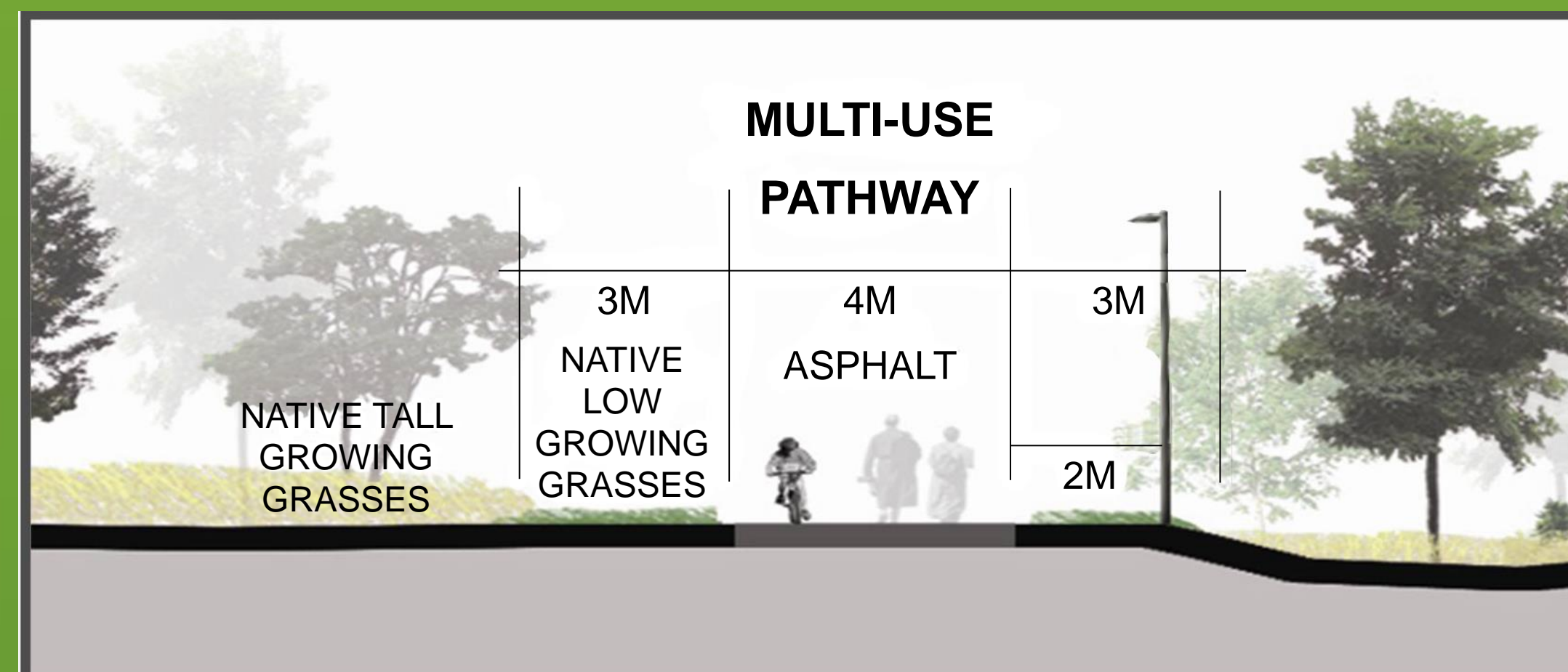

Section: Primary Multi-Use Pathway

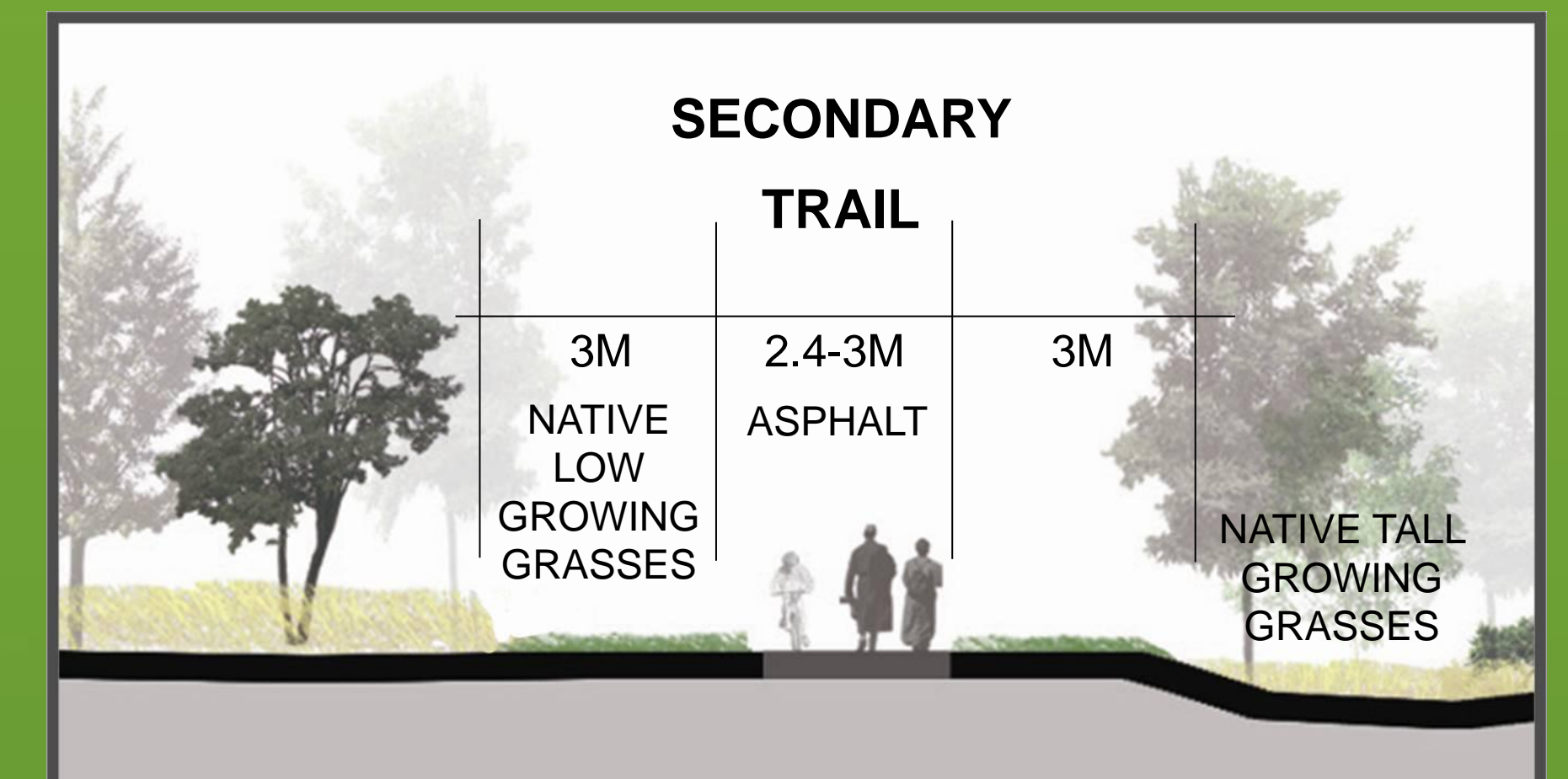

Section: Secondary Trail



- Legend**
- Primary Barrier Free Multi-Use Pathway (Paved and Lit)
 - Primary Trail Crossings
 - Community Connections
 - TB Trail Bridge TU Trail Underpass



- Legend**
- Secondary Multi-Use Pathway
 - () Secondary Trail Crossings
 - ↔ Community Connections
 - TB Trail Bridge TU Trail Underpass



TRAILHEADS

Location: At the start of the trail system at either end of the Parkway - Malden Road, Howard Avenue, and Howard Avenue Diversion.

Amenities: Granular Surfacing, Bench, Waste / Recycling Receptacle, Emergency Call Station, Shade Structure, Trail Map Sign & Information.

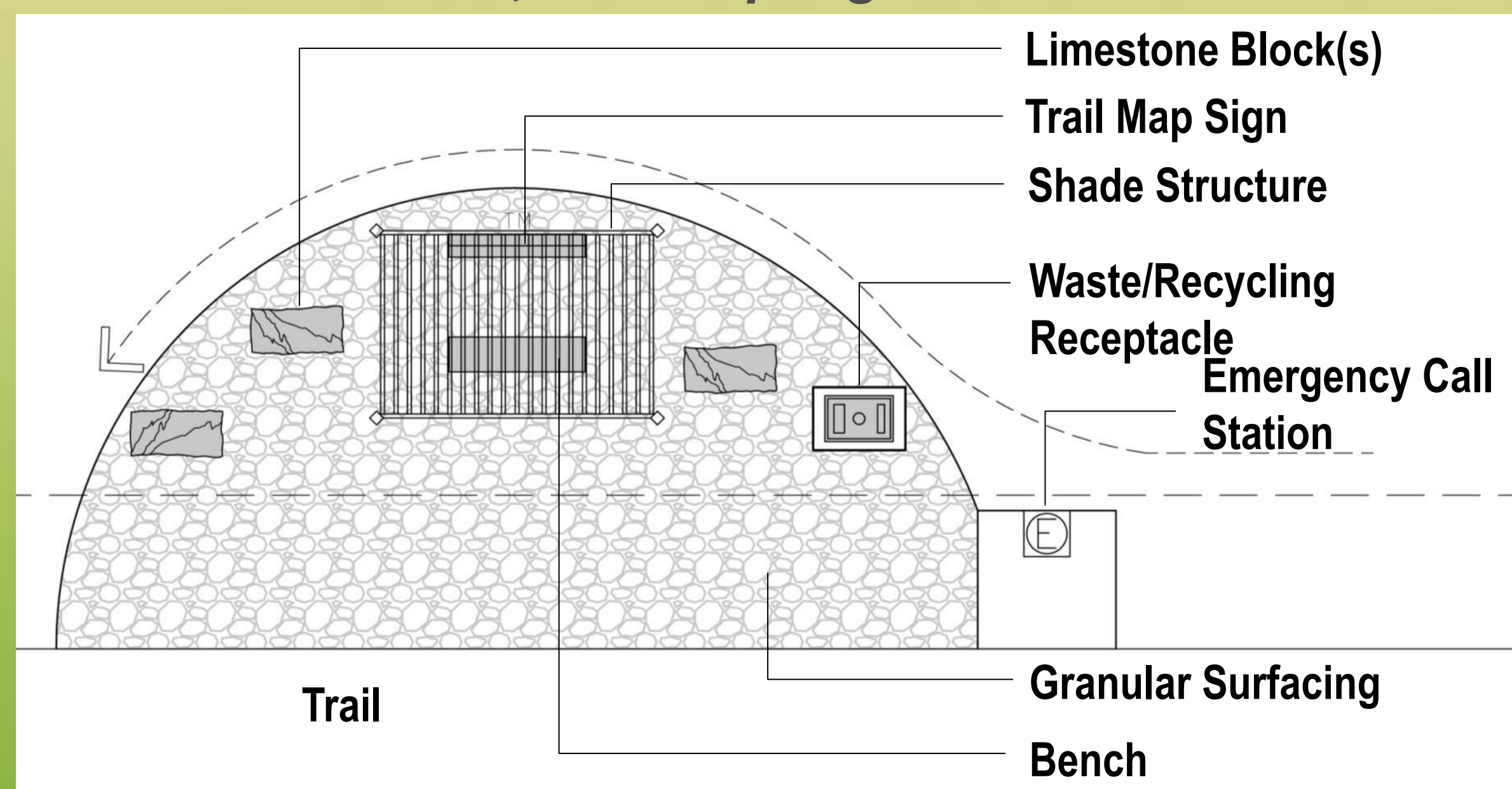

SITE FURNISHINGS



Trail Information & Map Signboard



Bench



Recycling / Waste Receptacle

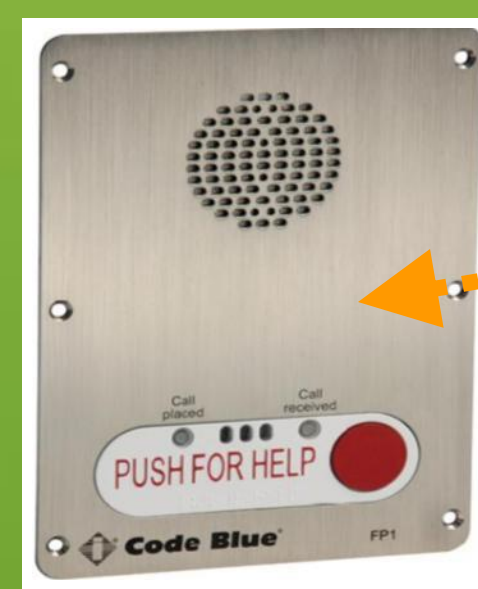

Emergency Call Station



Flat Trellis Shade Structure at Tunnels Top Rest Areas



Gable Trellis Shade Structure at Trailhead



Nickel colour for benches and recycling/waste receptacles



Stone blocks may be used for additional seating and landscape accents



Rest area pavers at T2, T8 & T10. Main area in Buff, Accent Banding in Onyx Colour



Rustic rest area pavers at T1, T3. Main area in Sandstone, accent banding in Mahogany

TRAIL LAY-BYS

Location: Along the trail, near features such as stormwater ponds, restoration areas.

Amenities: Granular surfacing, Stone blocks for seating, May have interpretive signs, depending on the location.

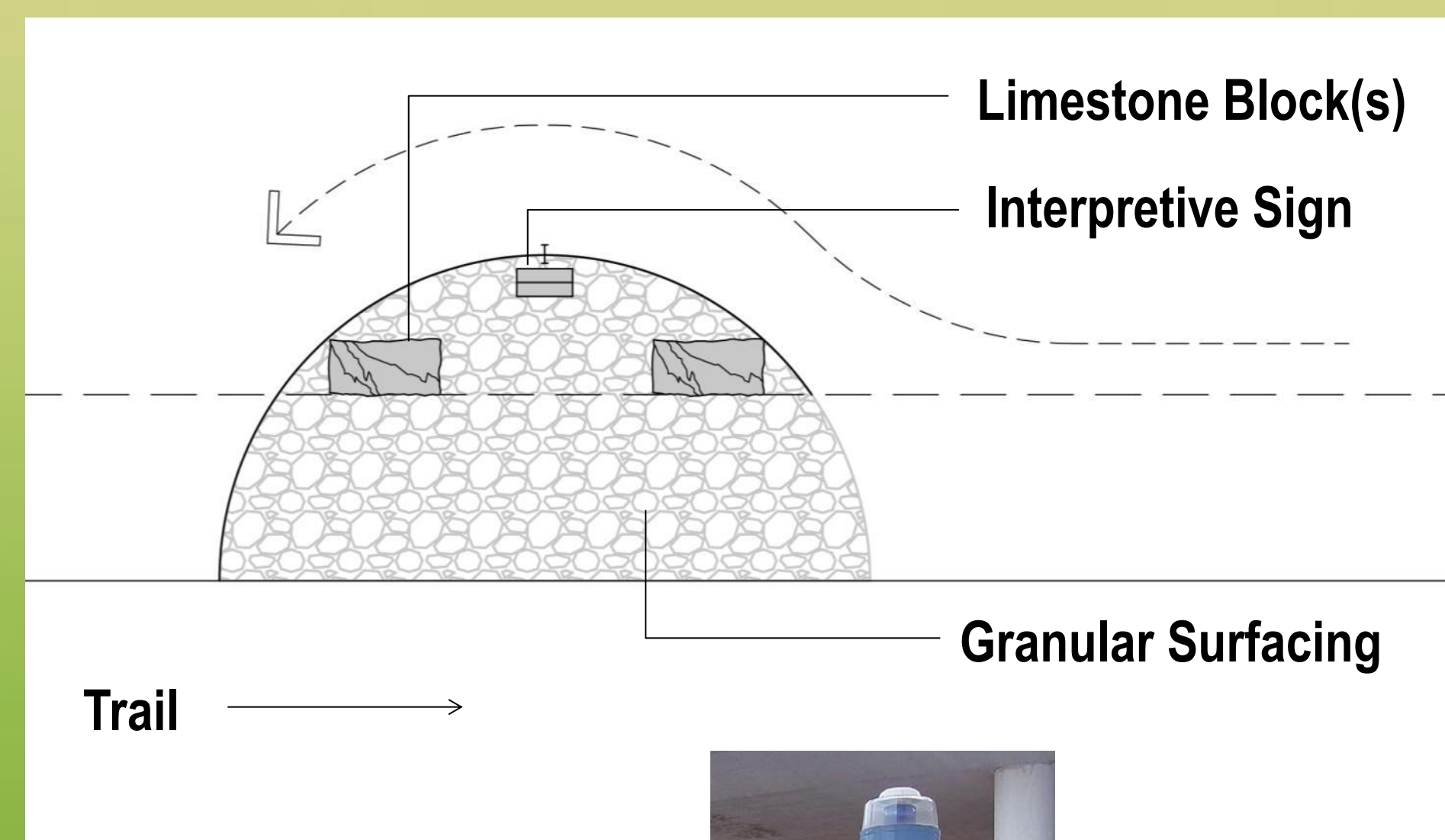

URBAN REST AREAS

Location: Along the trail, not more than 2km apart, on key tunnel tops. T1, T2, T3, T5, T8, T10

Amenities: Unit Pavers (except T5 which is granular), Bench, Waste / Recycling Receptacle, Emergency Call Station, Trail Map Sign & Information. May have Shade Structure or Interpretive Sign

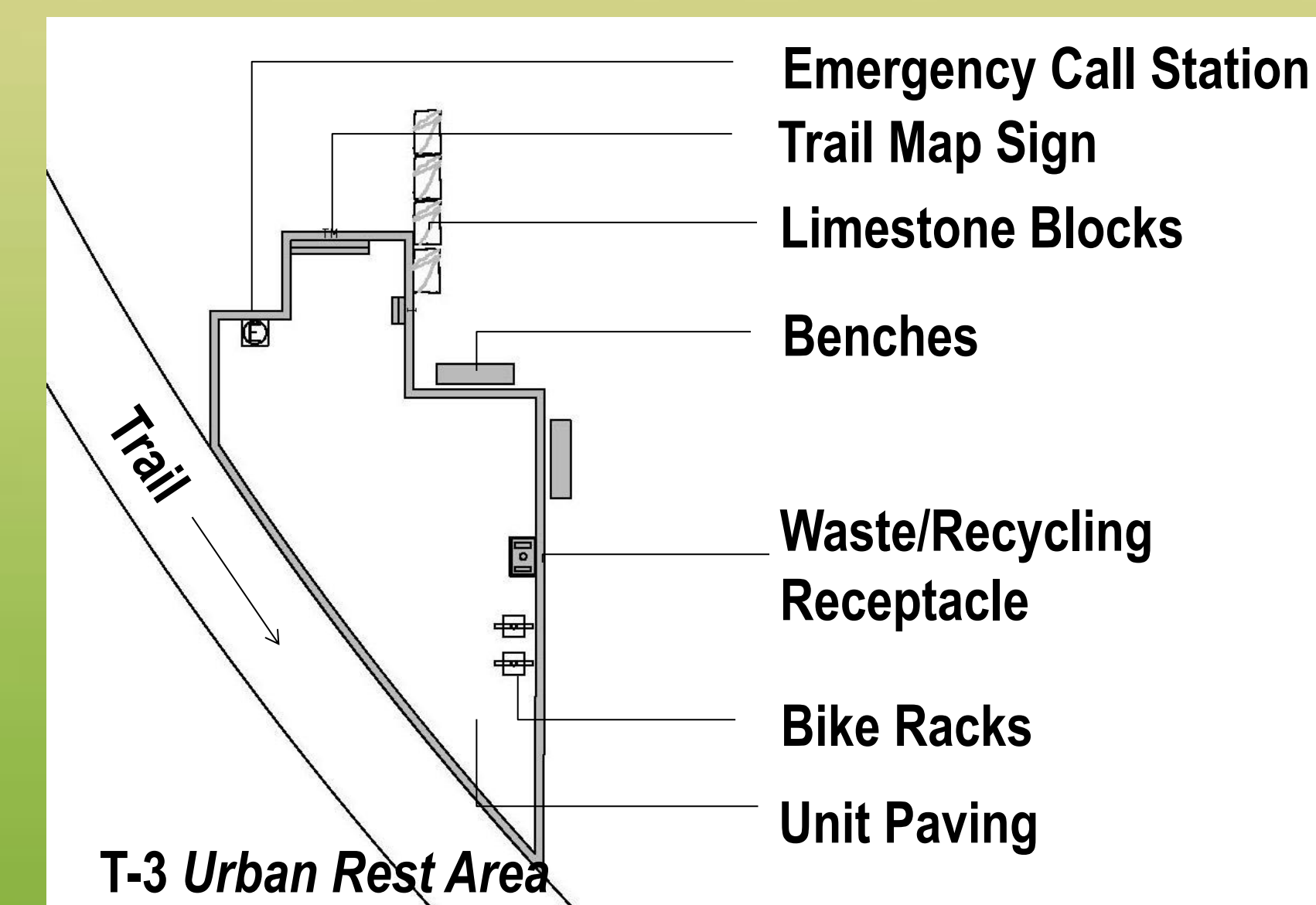

T-3 Urban Rest Area

See Landscape Plan for locations of Trail Amenities

Trail Lighting

- Lighting is provided along the multi-use pathway at the trailheads, street crossings, entrances and exits of trail bridges, and rest areas. Lighting will be:
 - dark sky compliant to minimize light pollution;
 - downcast with full cut off and additional shielding adjacent to residential communities;
 - contemporary styled LED fixtures



Trail lighting



Trail lighting pole colour

See Landscape Plan for locations of Trail Signage

CAUTION SIGNS

A range of regulatory and warning signs will be installed along the trail to advise users and promote trail safety. Examples are shown below.

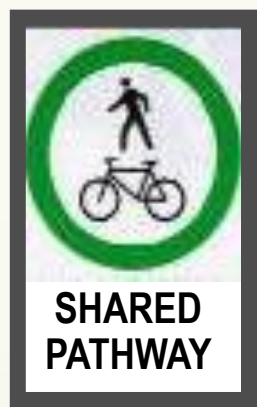

- The Parkway Trail will be a multi-use pathway. Signs advising of shared use will be installed at entrances to the trail and at 1 km intervals along the trail.



- Signs indicating that cyclists must dismount will be placed at crosswalks of public roads.

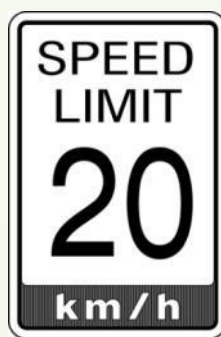

- The posted speed limit on the Parkway Trail will be 20 kilometres per hour. Speed limit signs will be installed at entrances to the trail and at 1 km intervals along the trail.



- Sign advising trail users to stop as they are approaching the main trail and the main flow of traffic.

WARNING SIGNS

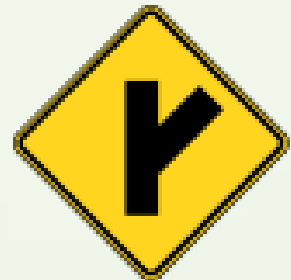

- Signs that warn cyclists of trail intersections, curves or changes in trail grades will be placed along the trail where appropriate.

***Signage will use international symbols or be bilingual

See Landscape Plan for locations of Trail Signage

WAYFINDING SIGNS

Wayfinding signs will be installed at 1km intervals and trail junctions along the primary multi-use pathway to direct users to trail bridges, municipal roads, rest areas and nearby municipal parks and facilities. Design details and examples photos are shown below.

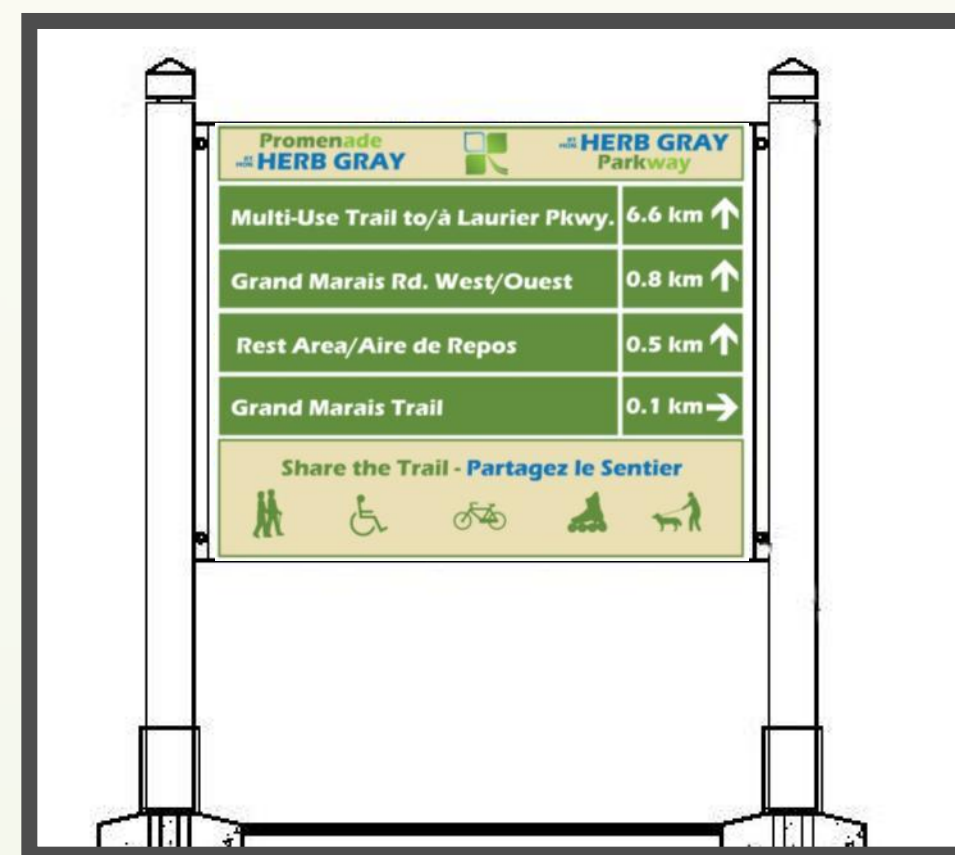

Wayfinding signboard detail

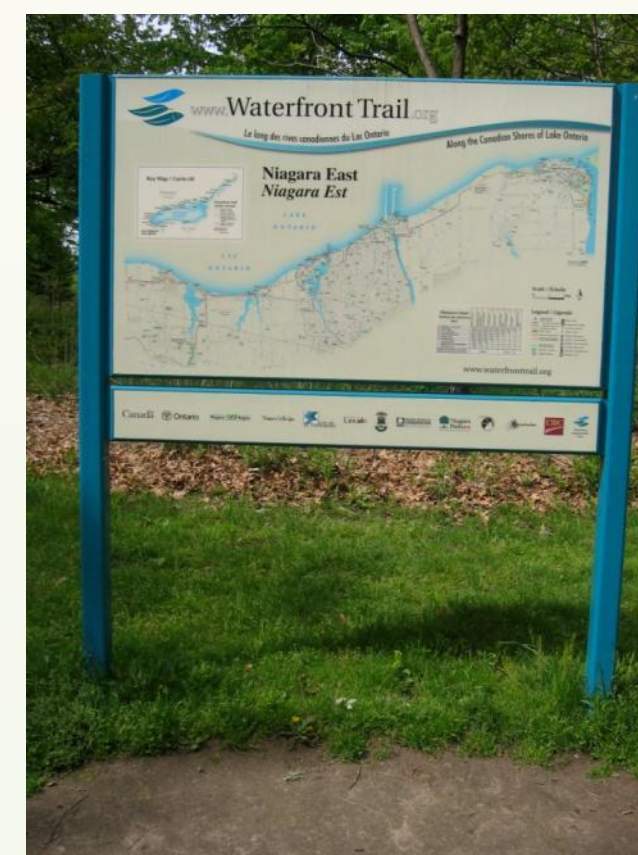
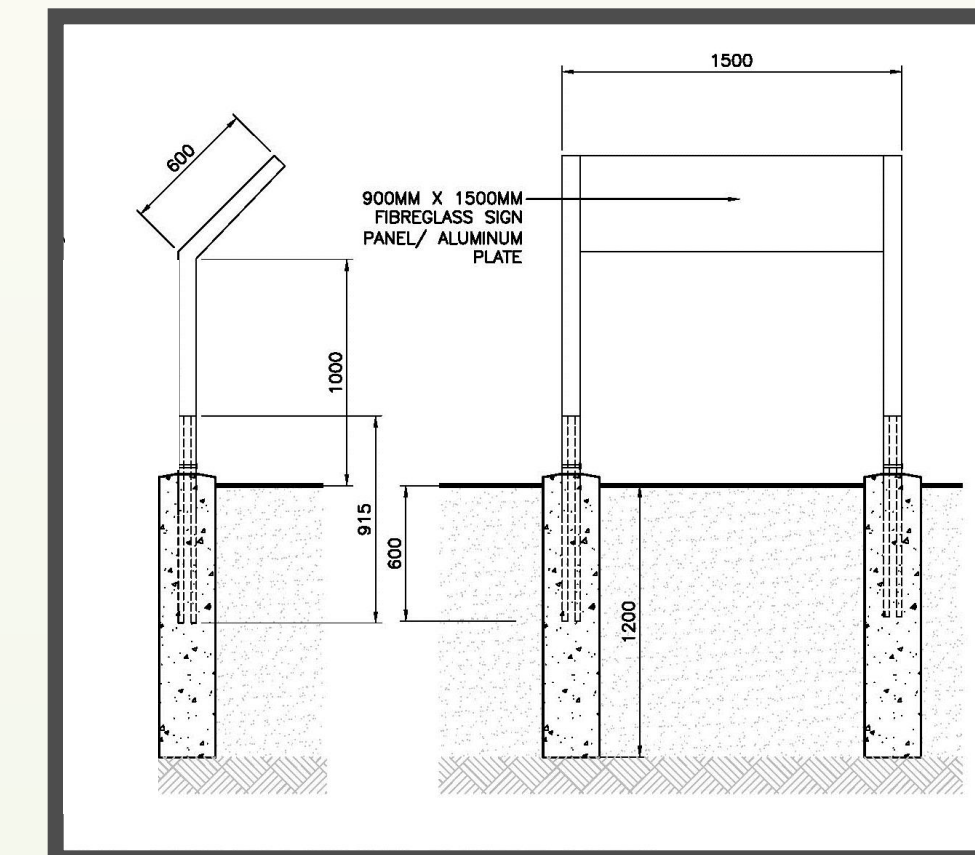

Photo example



Trail map / information signboard. Signage will be bilingual.

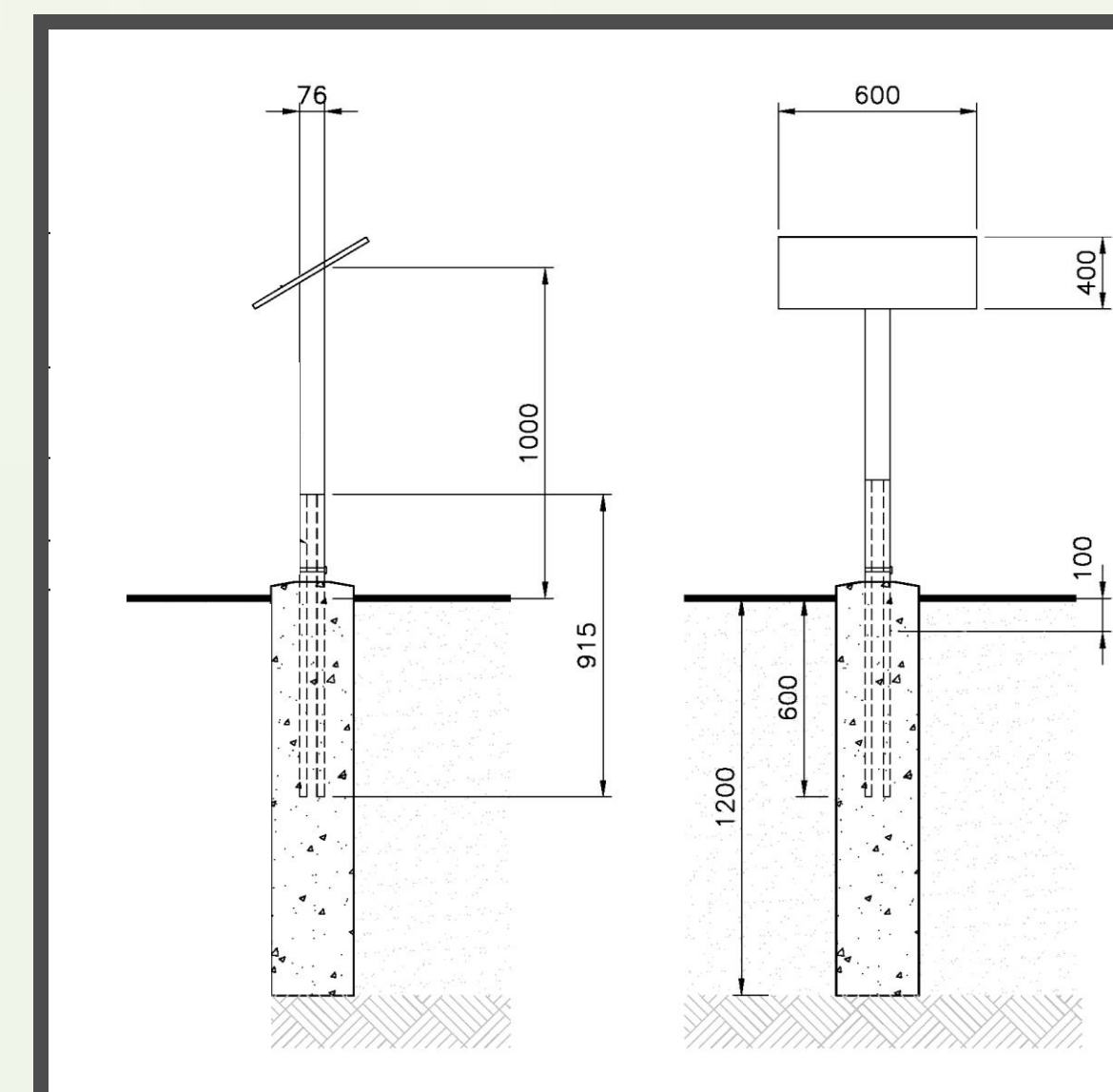

Photo example

INTERPRETIVE SIGNS



Photo example



Interpretive sign detail

- Interpretive signs will be located at selected tunnel top rest areas and some lay-bys along the trail where there are features of interest.
- Information will include both natural heritage and cultural heritage themes, such as: *About the Rt. Hon. Herb Gray Parkway; Prairie Restoration; Settlement in Windsor-Essex; Stormwater Management; Species at Risk; and, First Nations History and Teachings.*
- Interpretive signs follow provincial guidelines for signage.

***Signage will be bilingual

PEDESTRIAN BARRICADES

Pedestrian barricades are located throughout the Parkway in locations where the trail user may require safety measures due to increased slope. These areas include the approaches to trail bridges, along the drains, and by the stormwater management ponds.

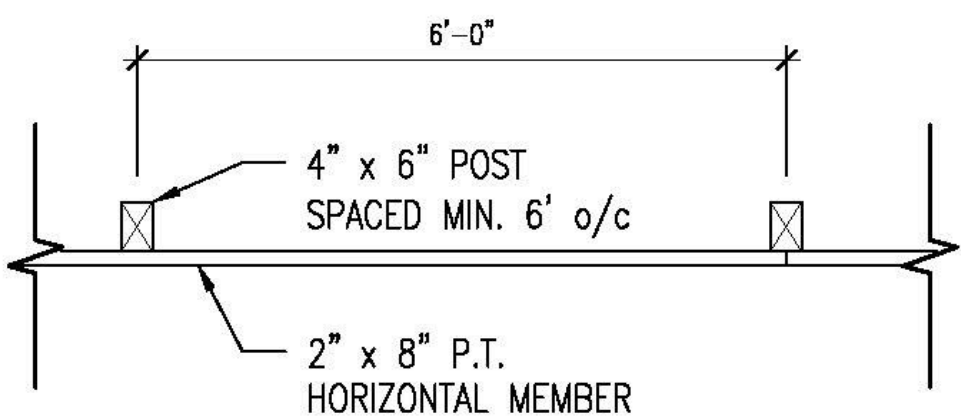

PLAN

SCALE : 1/2" = 1'-0"

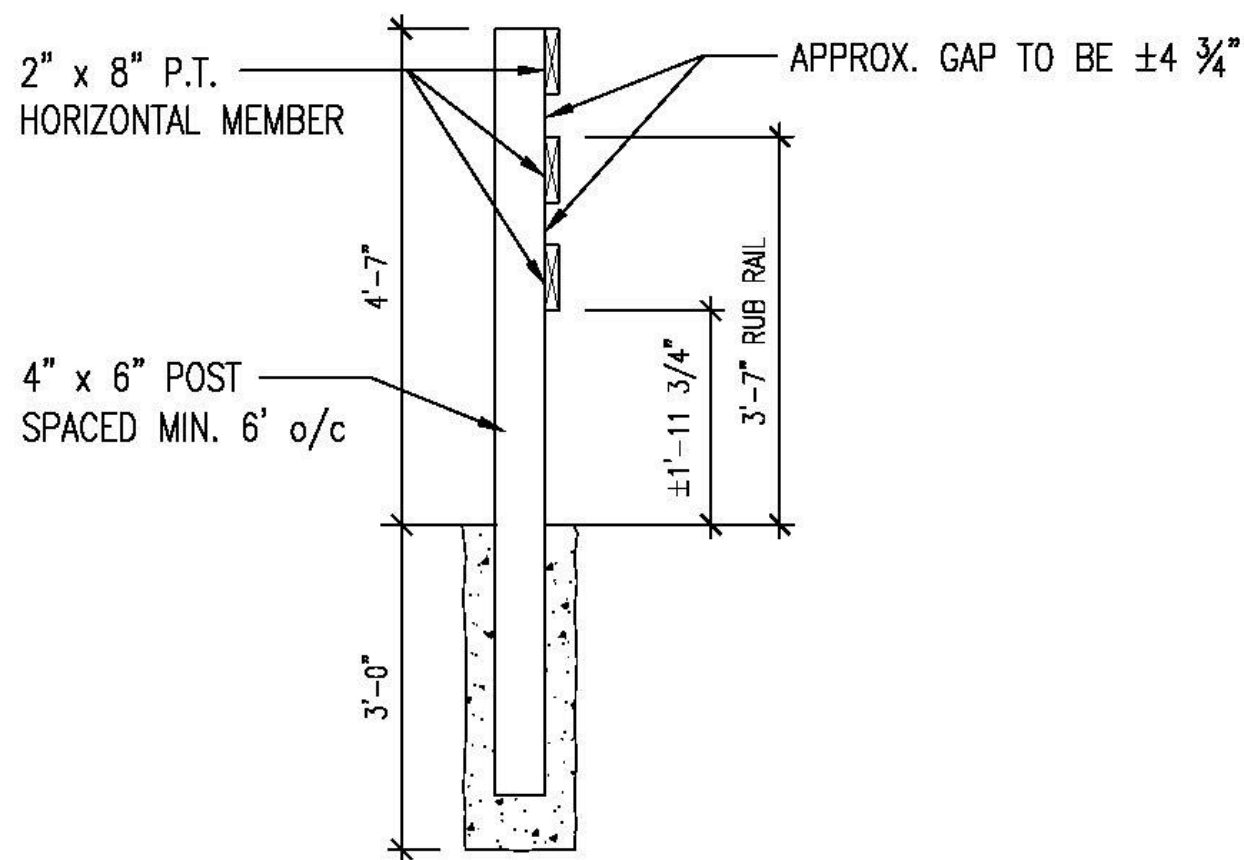

SECTION

SCALE : 1/2" = 1'-0"

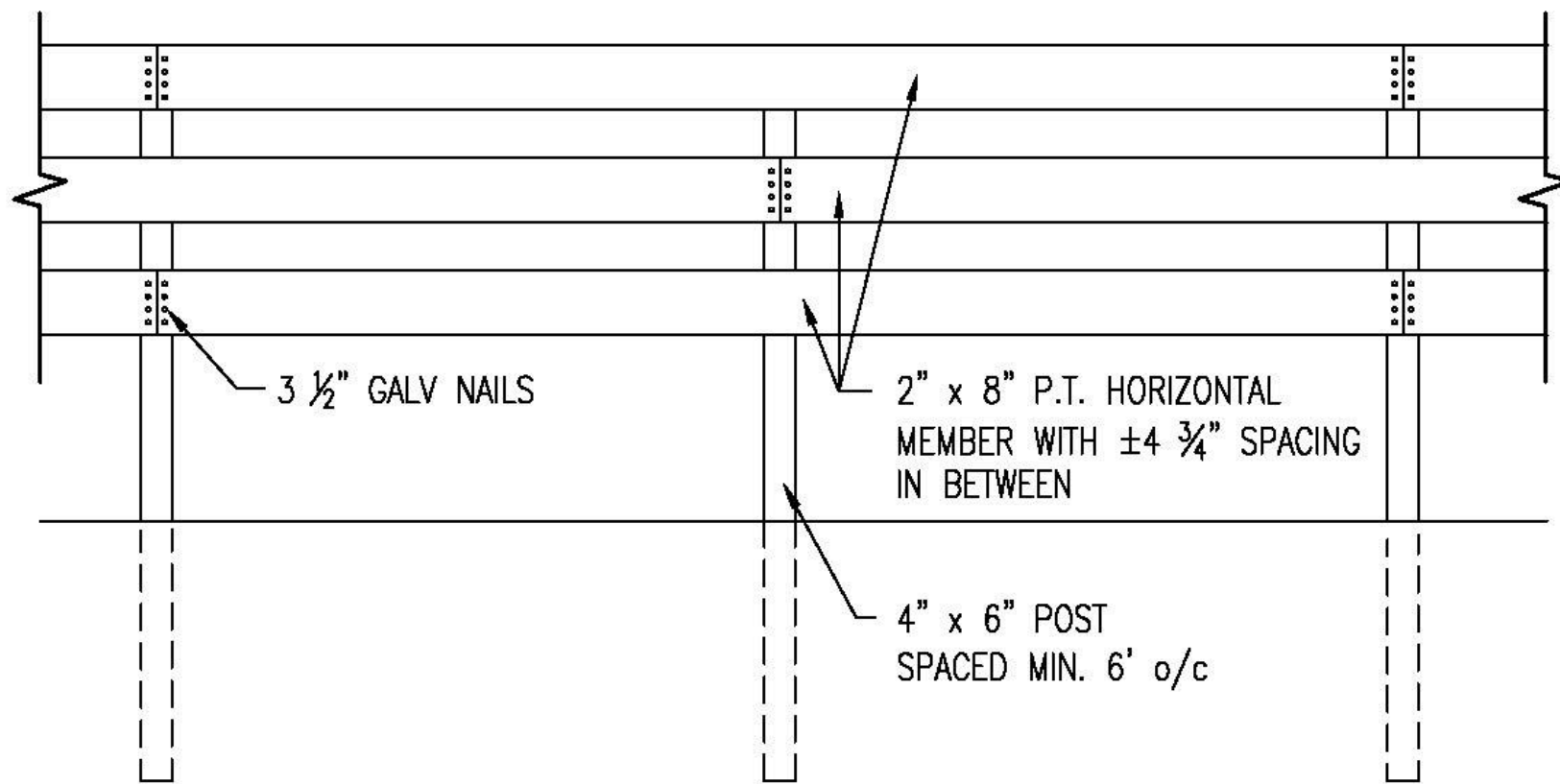

ELEVATION

SCALE : 1/2" = 1'-0"

NOTES:
FINISHED HEIGHT - MIN. 4'-7" (1.4m)
CONSTRUCTED IN ACCORDANCE WITH O.B.C. (2006)
RUB RAIL 43" (1.1m) ABOVE TRAIL GRADE
4" x 6" POSTS SPACED ±6' o/c
4" x 6" POSTS ENCASED IN CONCRETE
CONCRETE AUGERED FOOTING TO BE MIN. 10" DIA. x 36" DEPTH - 20 MPA
ALL LUMBER TO BE PRESSURE TREATED
ALL FASTENERS TO BE GALVANIZED.



Creative
HOMESCAPES
living beyond walls

STAMP:

1	10/10/13	UPDATED - SK	PROJECT NAME:	SCALE: AS SHOWN
			P.I.C. PEDESTRIAN BARRICADE (TRAILS)	DRAWN BY: M.F.
			ADDRESS: PARKWAY PROJECT WINDSOR/ESSEX COUNTY	CHECKED BY: S.K.
				DATE: OCT. 9, 2013
NO.	DATE	DESCRIPTION (REVISIONS)	DRAWING TITLE: PLAN, SECTION AND ELEV.	SHEET: 1

TRAIL BRIDGES

Trail bridges allow users to cross over the roads, highways and drains safely without needing to stop or dismount their bicycles.

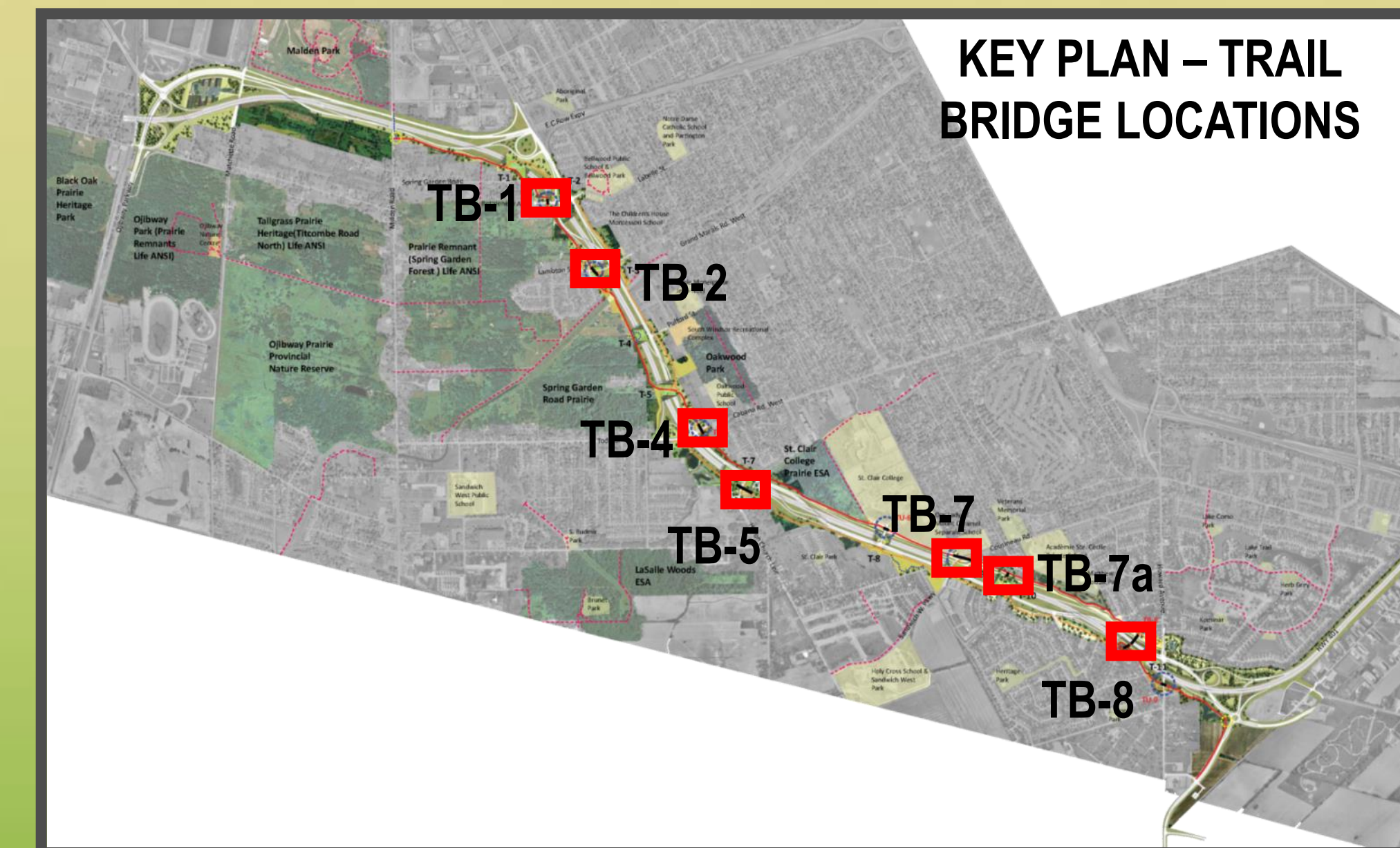
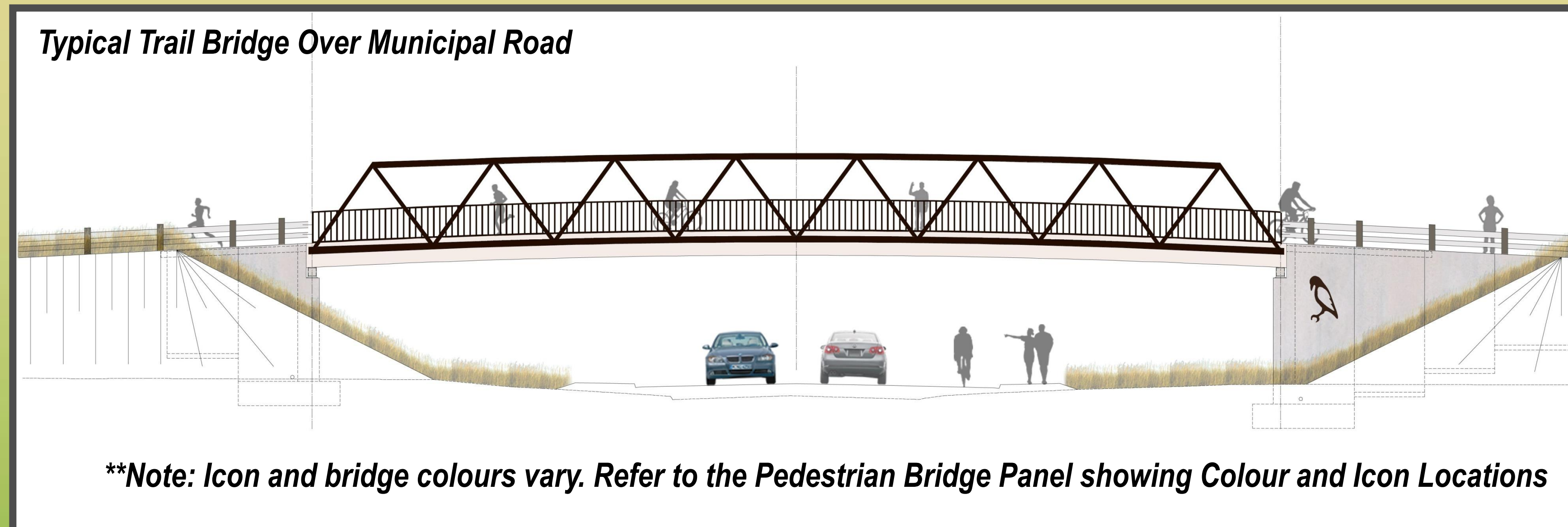

PEDESTRIAN TUNNELS

The two pedestrian tunnels, under Geraedts Drive and Howard Avenue, allow users to cross under roads without needing to stop or dismount their bicycles.

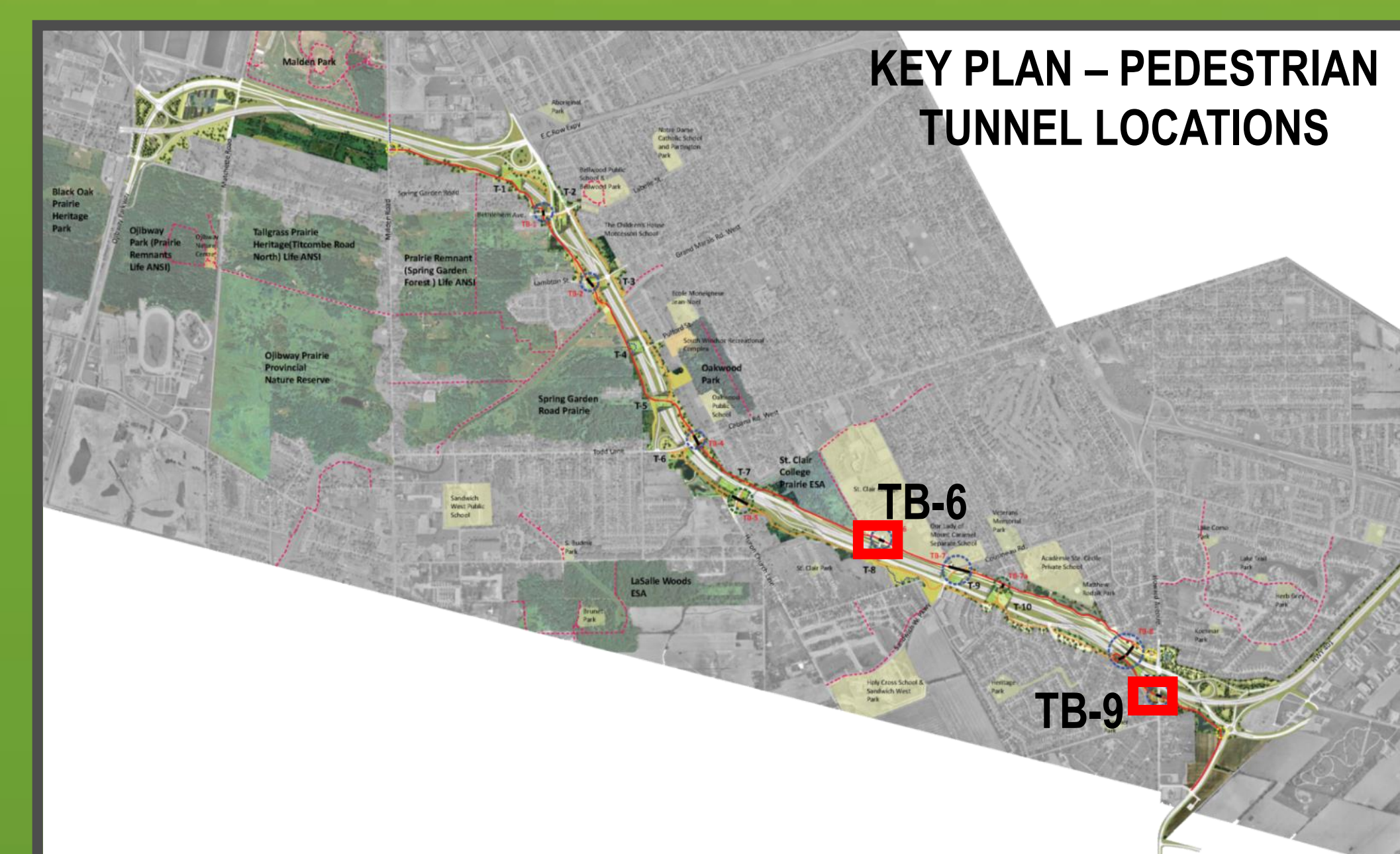

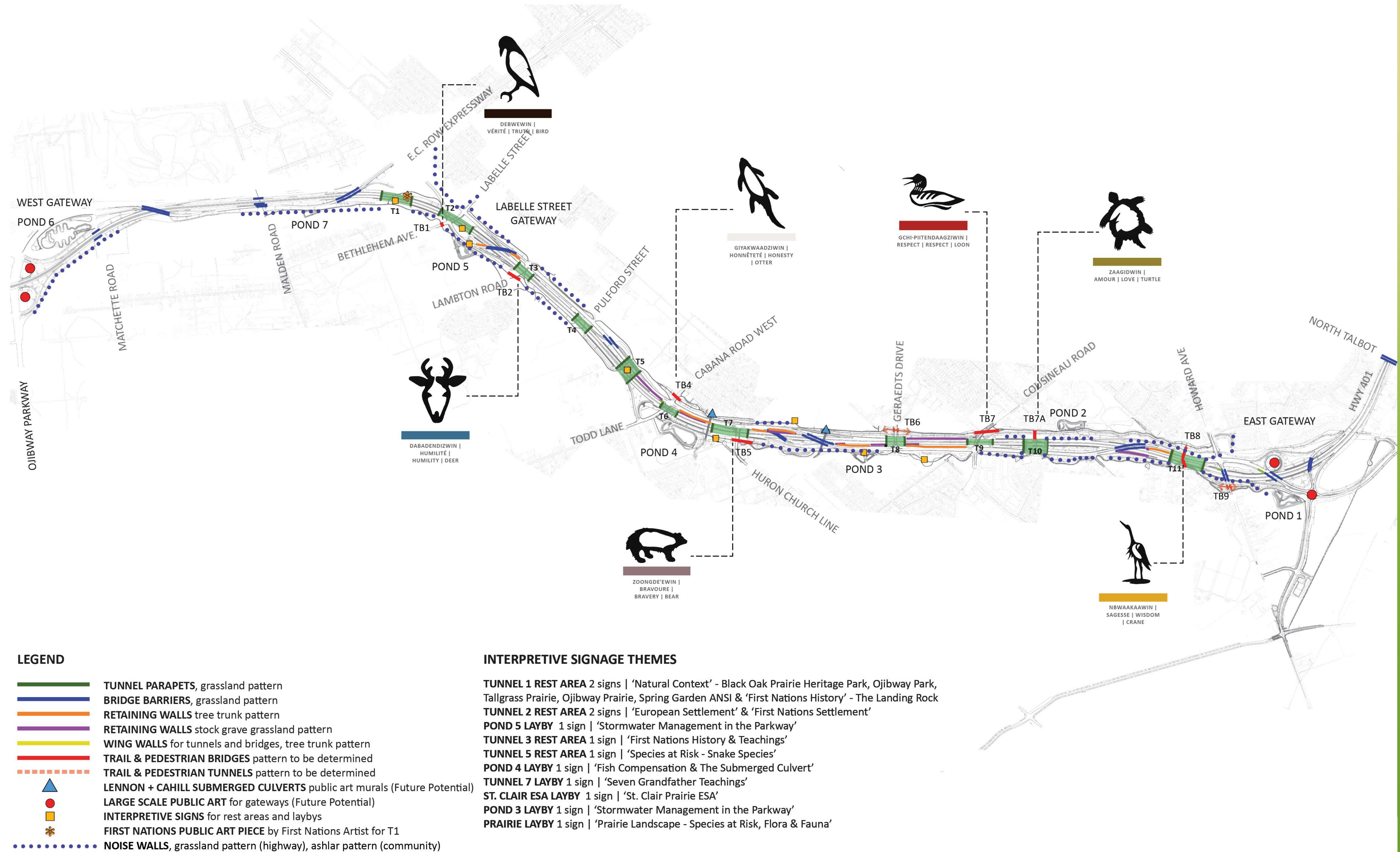

ILLUSTRATIVE PURPOSES ONLY - NOT FOR CONSTRUCTION

For the bridges, the inspiration for the theme came threefold from the significant colours, teachings, and clans of the local Anishinaabe First Nations (Ojibwe, Odawa and Potawatomi people) as interpreted by community members from Walpole Island First Nation.

The seven colours for the bridges come from the four colours of the Medicine Wheel and the three colours that represent life on earth.

The 'Seven Grandfather Teachings' are universal values to help us guide in our day-to-day living, including our interactions with the natural environment.

The Seven Teachings are:

Wisdom: knowledge, prudence intelligence

Love: to know love is to know peace

Respect: honour all creation

Bravery: fearless heart

Honesty: be honest in word and action

Humility: equal to others, not better

Truth: do not deceive yourself or others

The animal symbols are artistic representations of the original seven clans of the Anishinaabe people.

These themes have been interpreted and then applied to the seven pedestrian bridges for cultural significance. Trail side markers will introduce the themes at the approaches to the bridges.

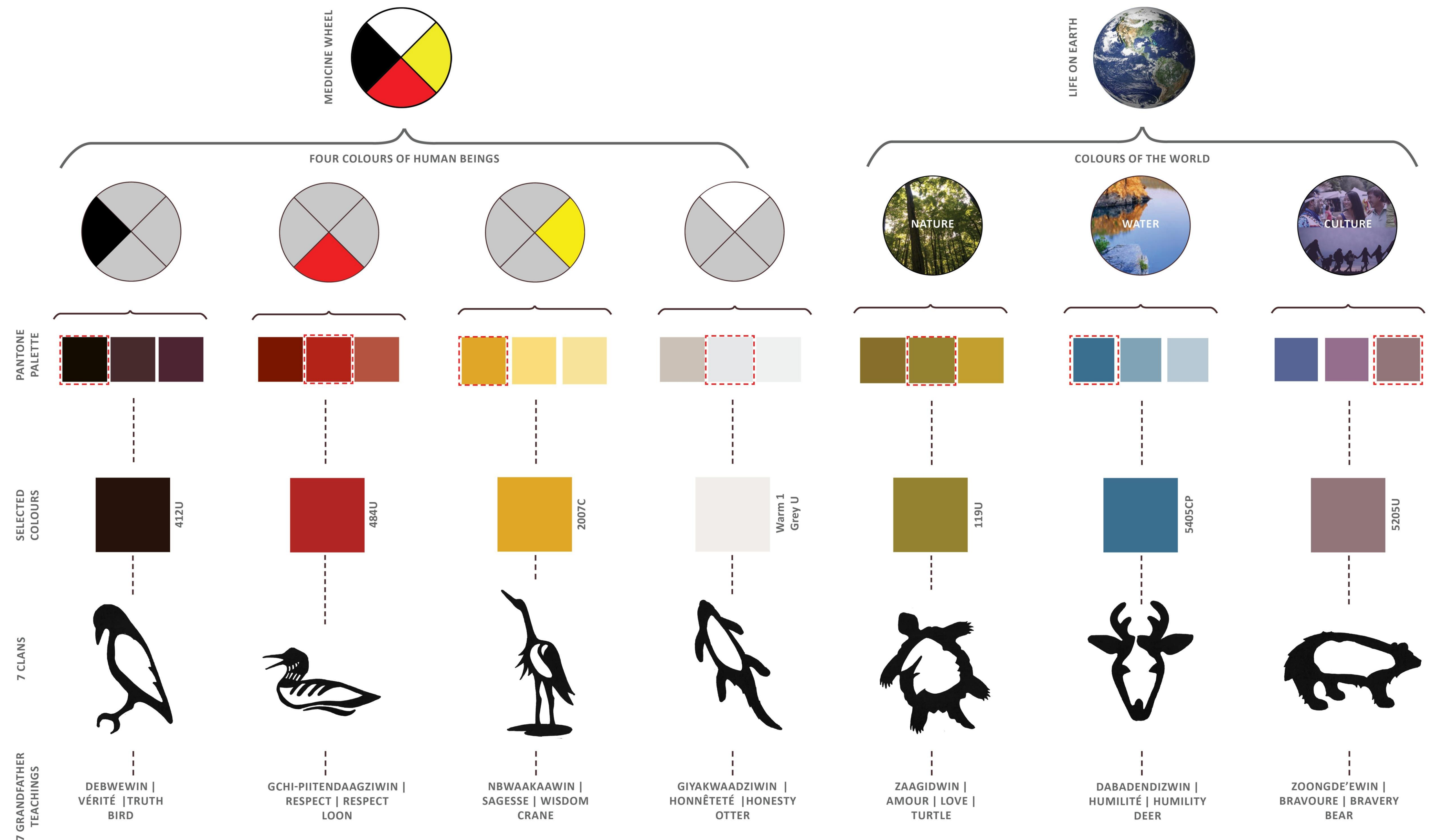

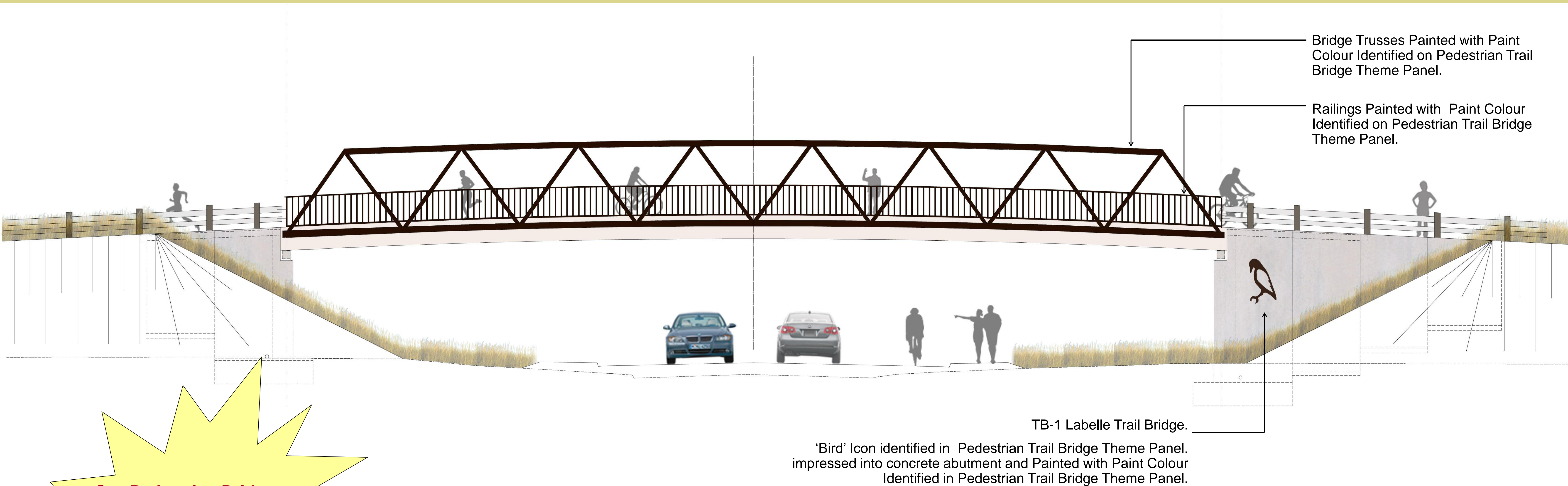

See Pedestrian Bridge Colour and Icon Location For Parkway Locations Of Bridges



Trails | Aesthetic Expression – Trail Bridge Markers

OPTION 1.1 – MONOCHROME METAL POST

Metal post painted with assigned colour. Laser cut metal plates with the assigned teaching in three languages mounted on three sides, plates painted with assigned colour.

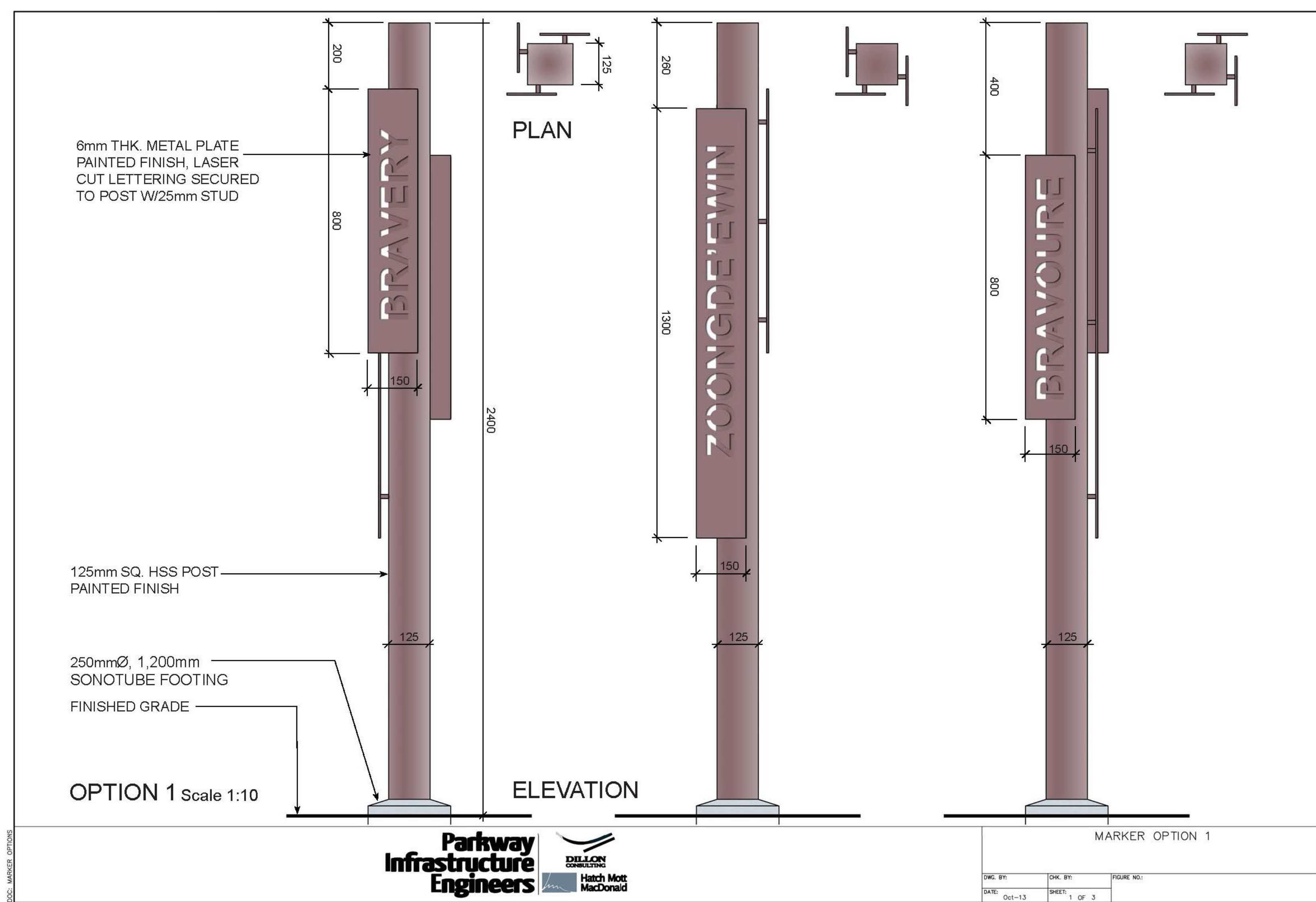

OPTION 1.2 – METAL POST WITH MULTICOLOURED PLATES

Metal post painted with assigned colour. Laser cut metal plates with the assigned teaching in three languages mounted on three sides, English plate painted with red colour, Anishinaabe plate painted in blue colour, French plate painted in chrome colour.

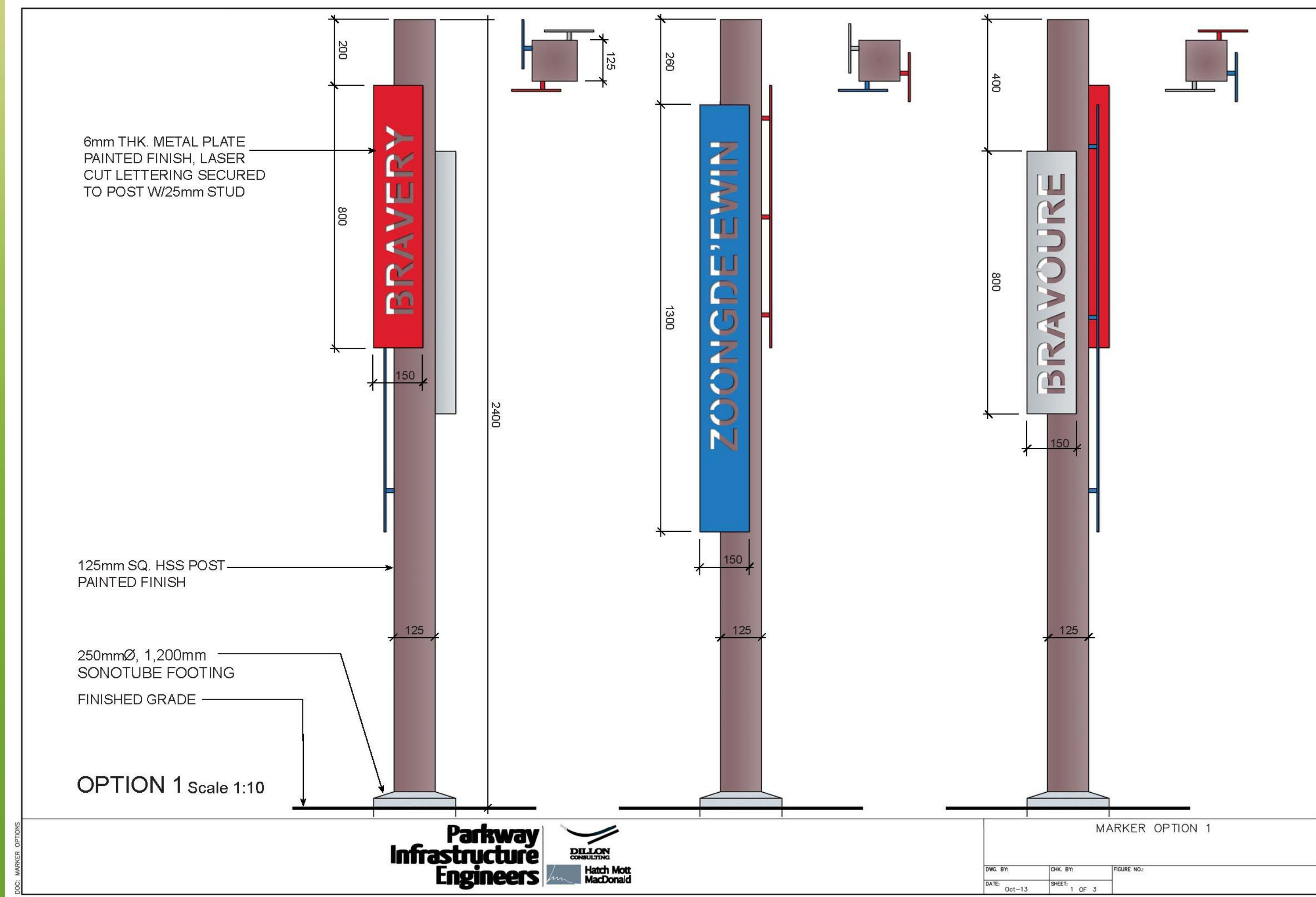



Trails | Aesthetic Expression – Trail Bridge Markers

OPTION 2.1 – WOODEN POST WITH MONOCHROME PLATES

Wooden post. Laser cut metal plates with the assigned teaching in three languages mounted on three sides, plates painted with assigned colour. Laser cut themeing element (animal icon), also painted with assigned colour mounted on 3 sides of the post.



OPTION 2.2 – WOODEN POST WITH MULTICOLOURED PLATES

Wooden post. Laser cut metal plates with the assigned teaching in three languages mounted on three sides, English plate painted with red colour, Anishinaabe plate painted in blue colour, French plate painted in chrome colour. Laser cut themeing element (animal icon), painted with assigned colour mounted on 3 sides of the post.

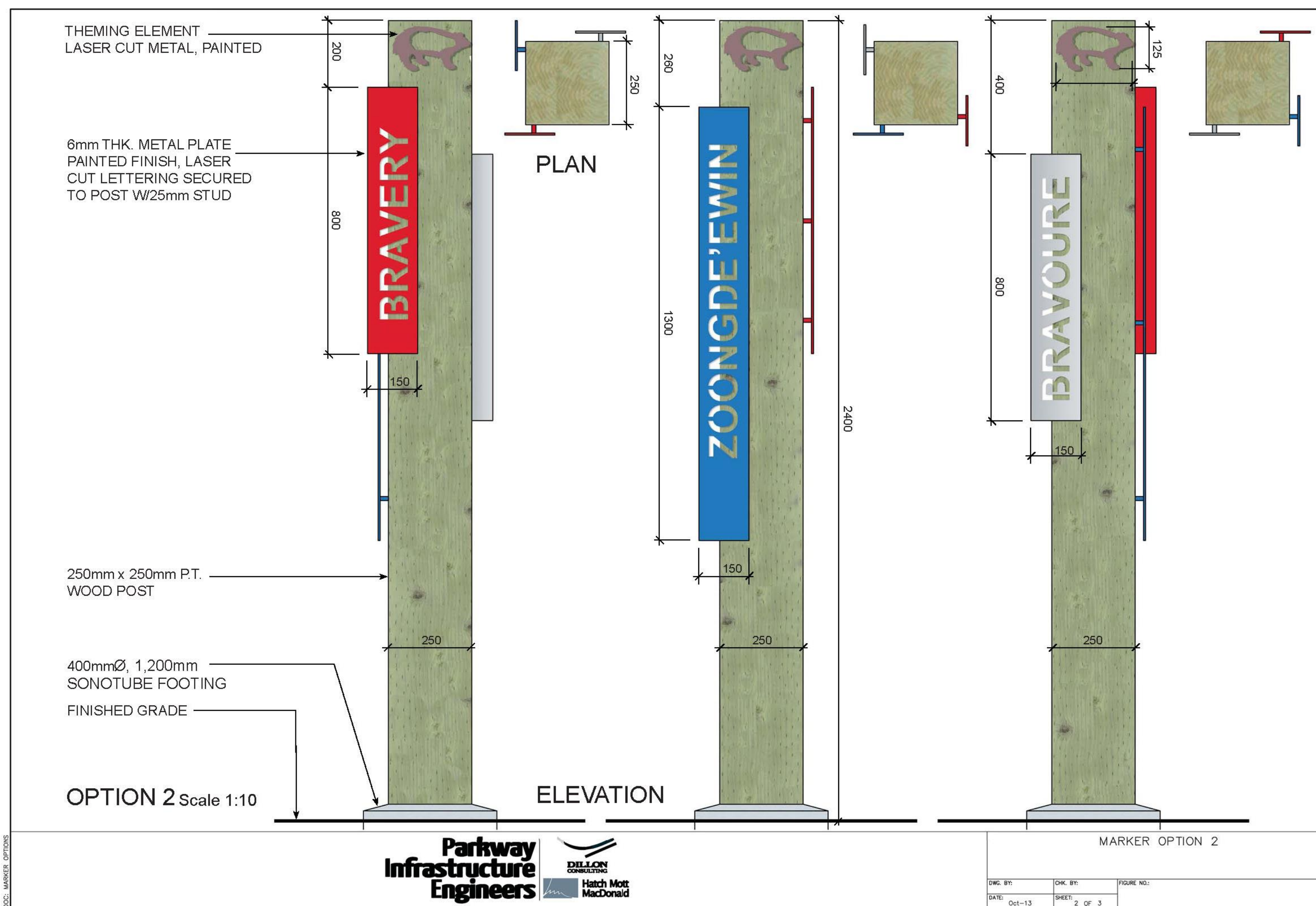



TRAIL BRIDGE MARKER FOR TB 7A – STONE MARKER

Trail Bridge 7a is the only trail bridge that lacks the concrete abutments needed for placing the clan icon. This stone marker will be placed near the approach of the bridge and will contain the turtle clan icon, the teaching in 3 languages, and these will all be sandblasted and painted with the green colour assigned.

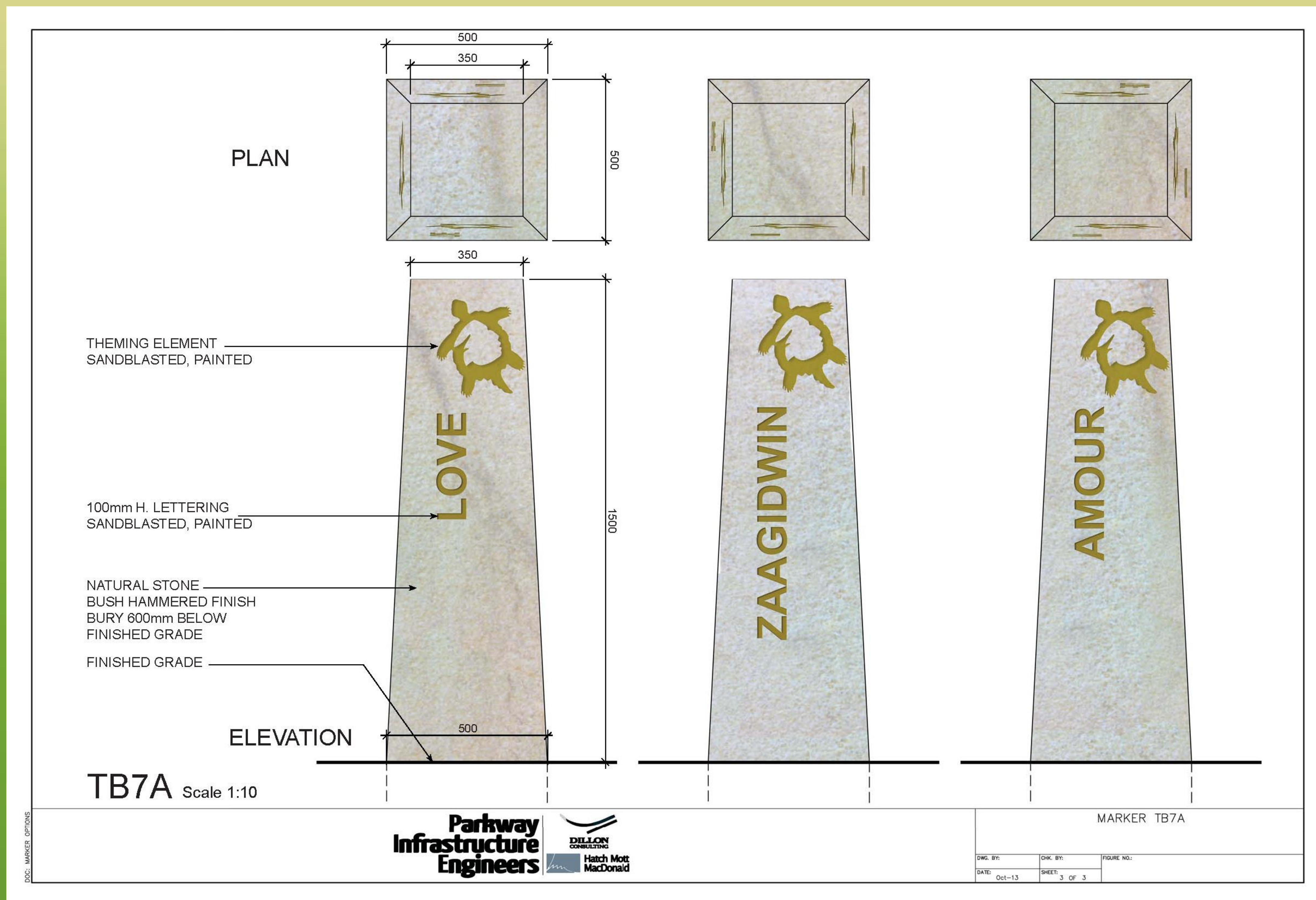

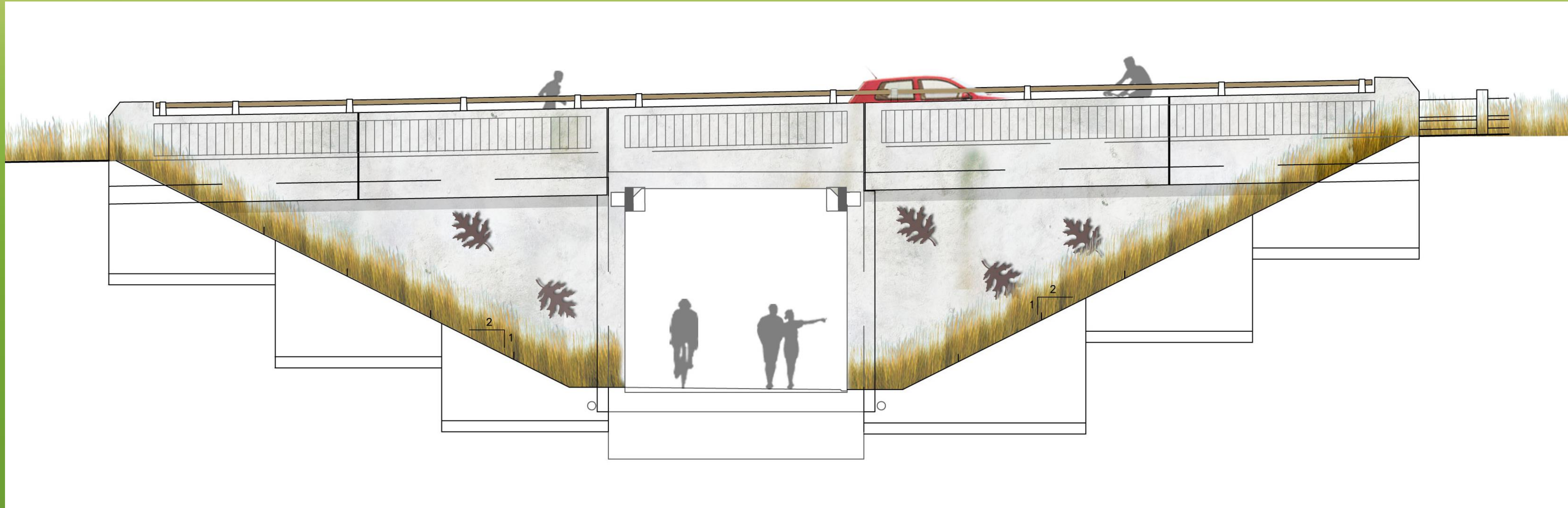
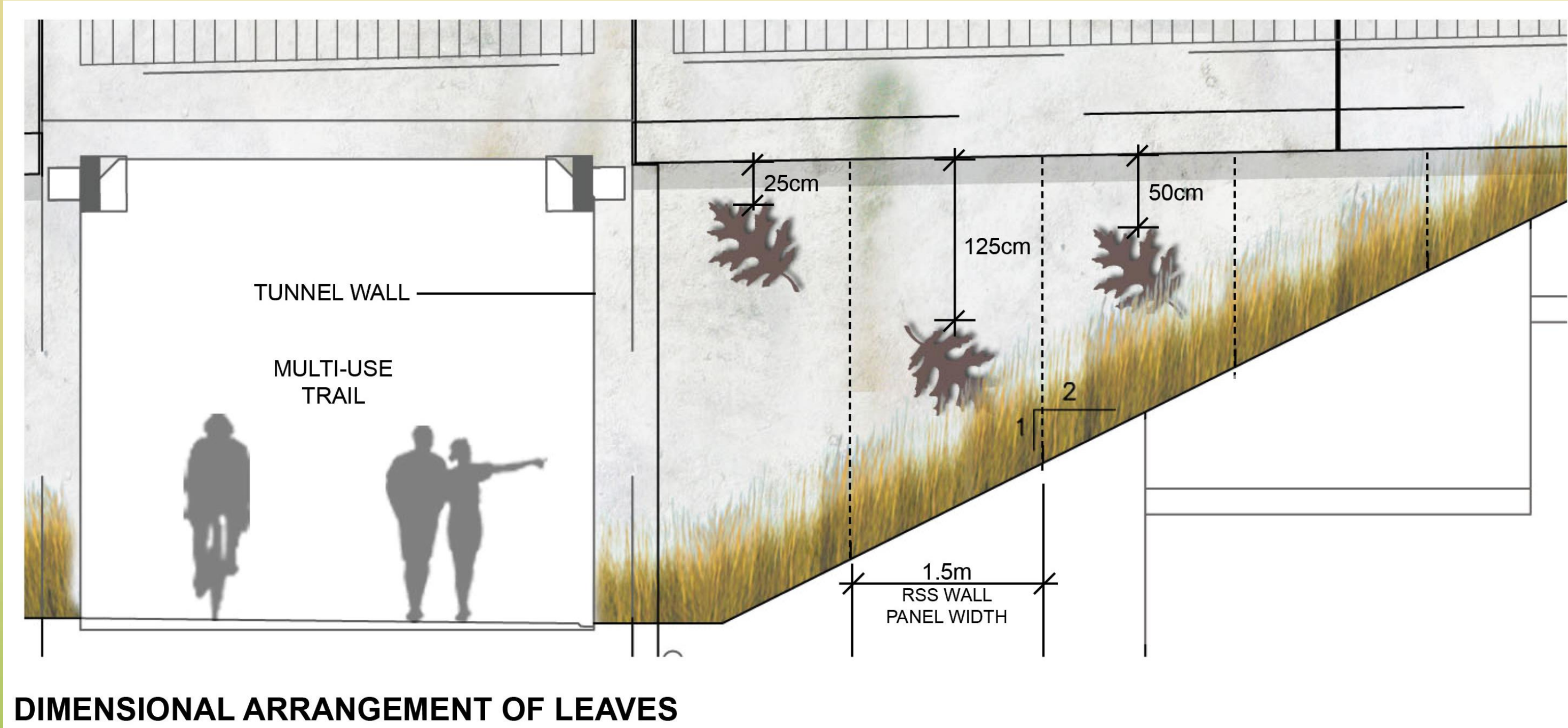
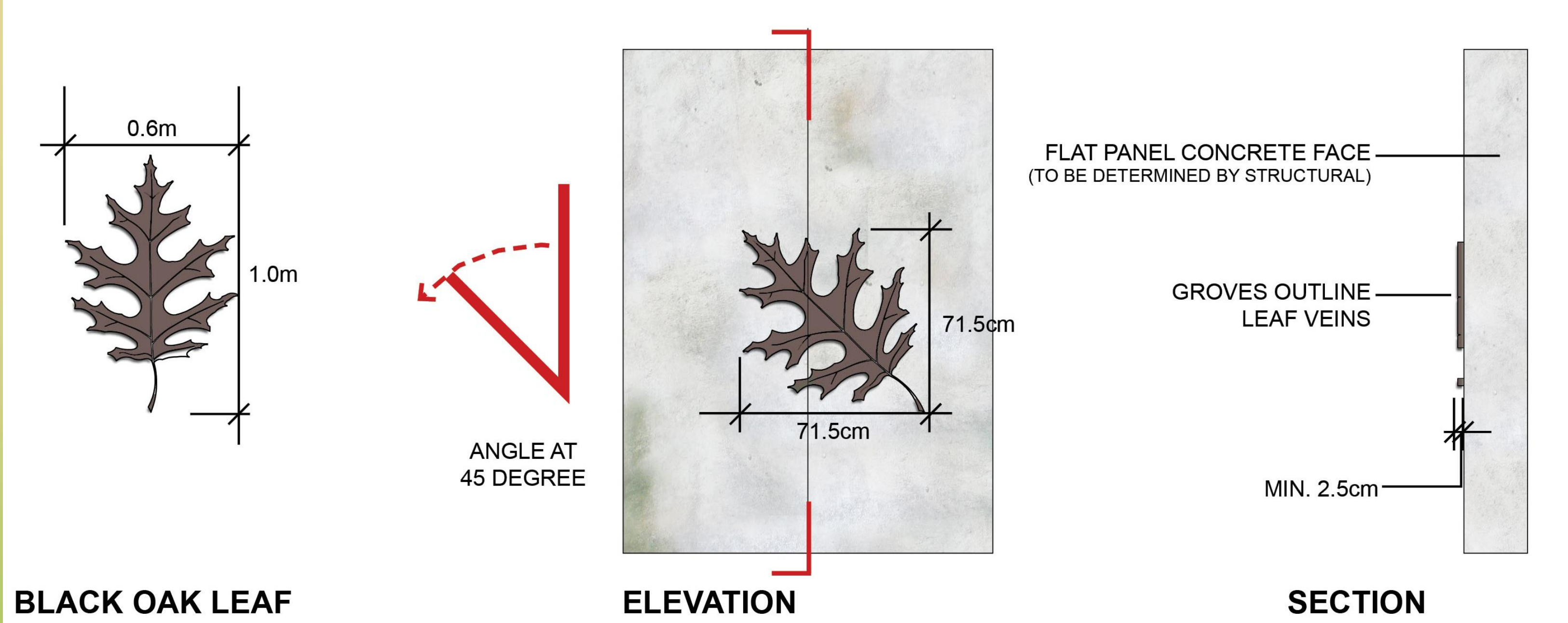

The colour of the Oak Leaf on the RSS panel (please see picture below) will be the same of the Maple Leaf below, which you can find at the Howard Avenue Grade Separation.



Black Oak Leaf.

It will be painted as the maple leaf beside.



Maple Leaf.

This colour will be used to paint the Black Oak Leaf

SAFE PASSAGE REST AREA CONCEPT

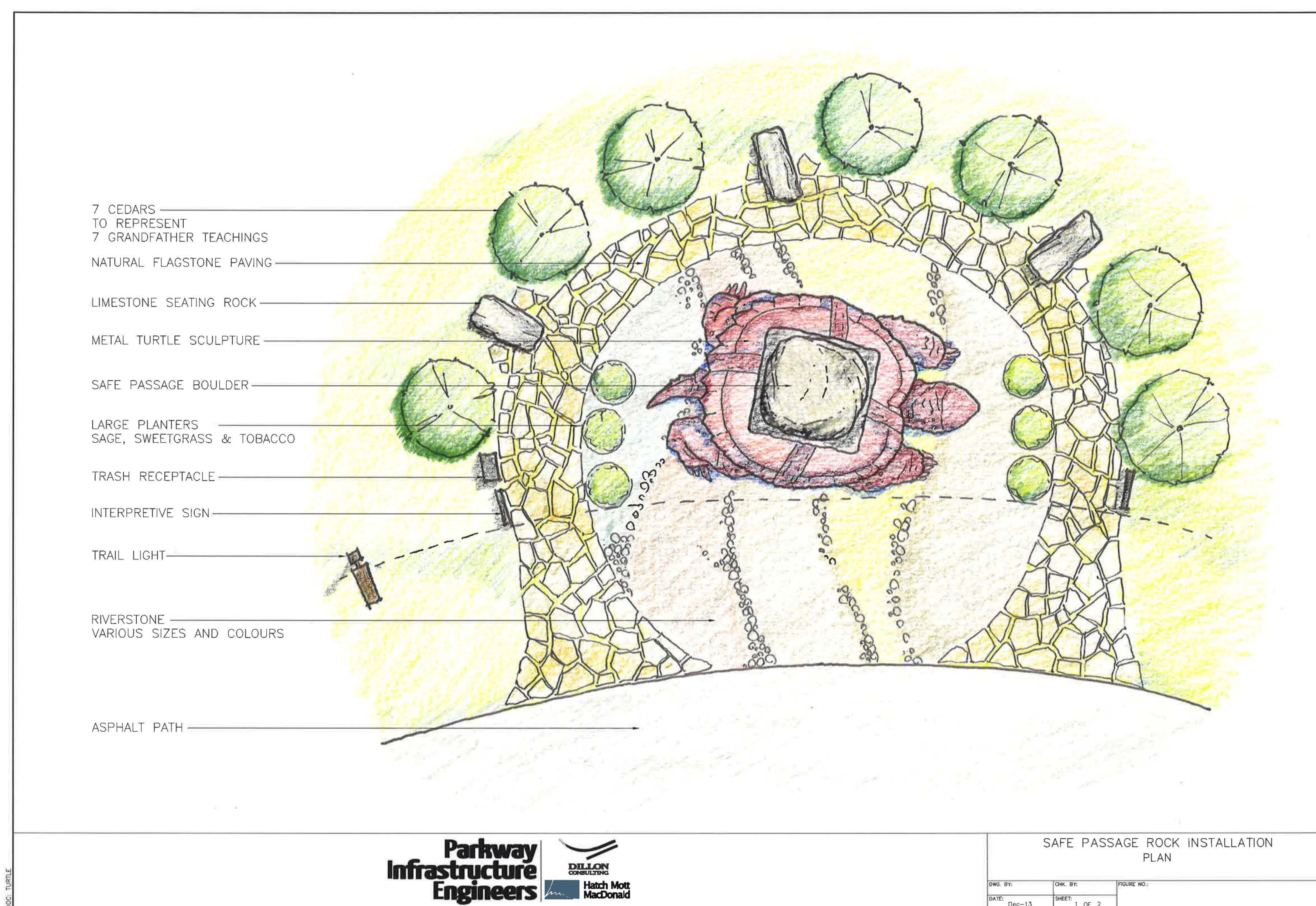

SAFE PASSAGE ROCK INSTALLATION SECTION

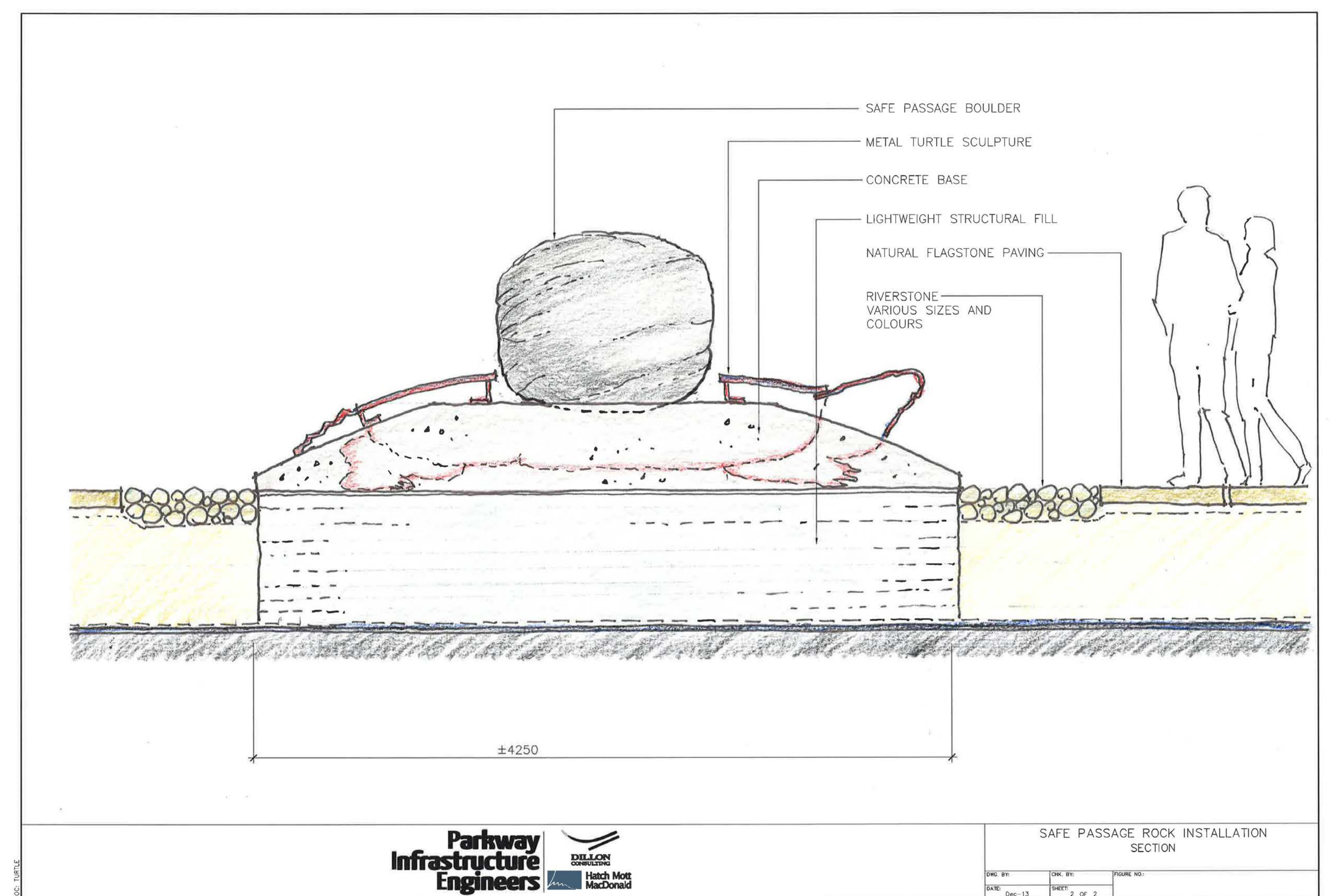

GRANDFATHER STONE

The turtle (Mzhiikenh, in the Ojibwe language) is legendary to First Nation people. After the Great Flood, Mzhiikennh offered its back, its shell, for the sacred earth to be placed upon. The Winds from the Four Directions blew and blew and the Earth grew and grew. It became North America, the homeland of all First Nations people and called by many as Turtle Island. You are now standing on the back of the Great Turtle. Mshiikenh is honoured to carry the “Mishomis Sin” Grandfather Stone. The original Mishomis Sin was located not far from here along the Detroit River and was honoured by the First Nations people who were grateful for passing safely across Lake Erie. Missionaries Galinee and Dollier destroyed this sacred stone when they journeyed up the Detroit River for the first time in 1670. The stone used here is a limestone glacial erratic that was found during the excavation of the Herb Gray Parkway.

